

AROL 201
ARCHAEOLOGY IN LEBANON
FINAL EXAMINATION

DATE: FEBRUARY 2, 2008

TIME: 2 HOURS, 3:00-5:00 p.m.

Answer All the following questions.

Write your answer in the blank space left below the question.

Read the questions carefully before answering them.

GOOD LUCK!

Question 1: Identify, date and comment briefly on the following slides:

Side 1, 3%



Slide 2, 3%



Slide 3, 3%



Slide 4, 3%



Slide 5, 3%



Slide 6, 3%



Slide 7, 3%



Slide 8, 3%

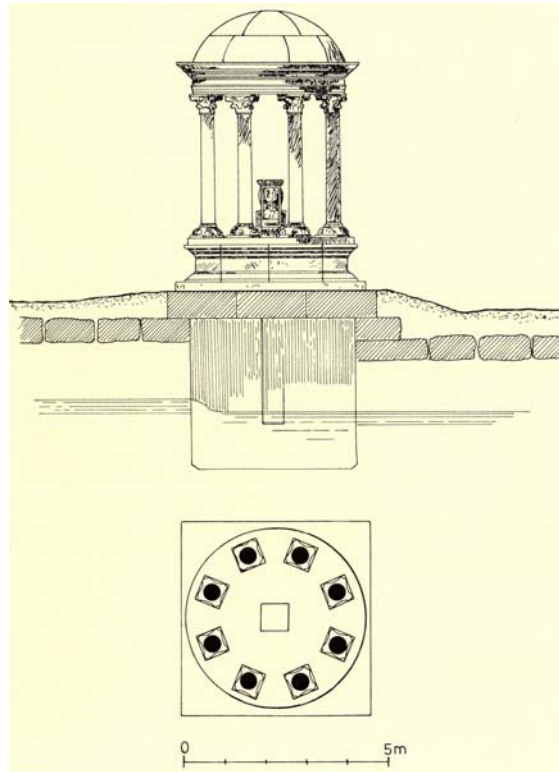

Slide 9, 3%

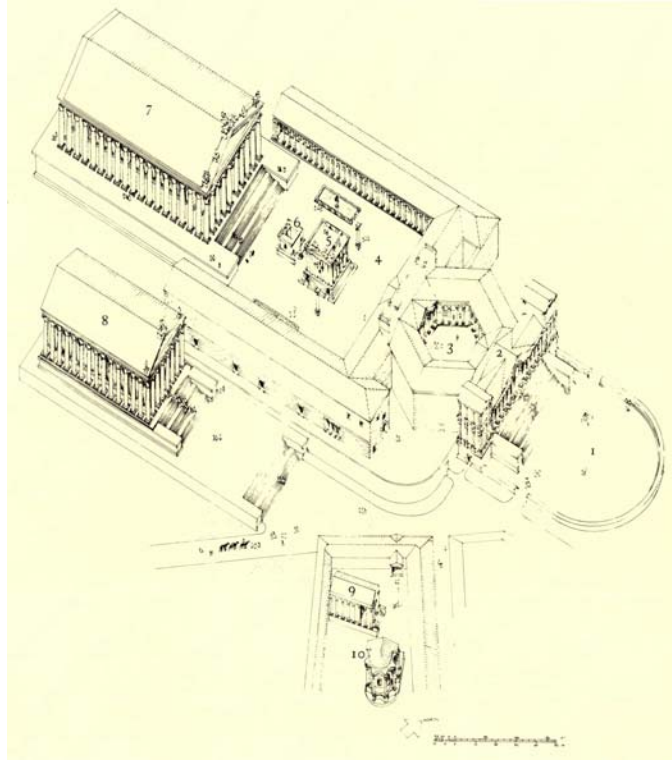

QUESTION 2 Write your answer in the blank space 8%

This is a sketch plan of a city excavated in Lebanon.

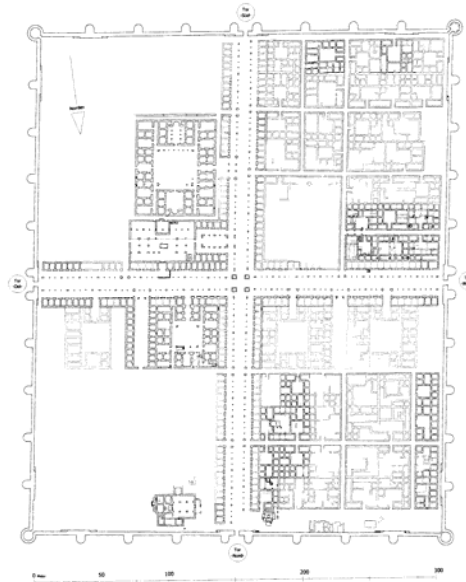

1-Identify the city

2-Identify, using numbers (1,2,3...), seven most important structures which appear on the plan and list them in the space reserved for each under the corresponding number.

1-

2-

3-

4-

5-

6-

QUESTION 3 Write your answer in the space below each question

In which Lebanese site(s) was an Iron Age (Phoenician) city wall excavated? **2%**

In which Lebanese site(s) were Iron Age (Phoenician) houses excavated? **2%**

In which Lebanese site(s) were Roman cemeteries excavated? **2%**

QUESTION 4 Write your answer in the space below the question

What types of public buildings survive in Tripoli from the MAMLUK period? Name one specific example of each type. **10%**

QUESTION 5: Write your answer in the space below each question

What is

- a *mihrab*? **2%**

-a portico? **2%**

QUESTION 6: Essay question Write your essay on the attached 2 pages

45%

ANSWER ONLY ONE OF THE FOLLOWING TWO ESSAY QUESTIONS:

Essay question 1: maximum 2 pages

In Lebanon there are several sites which have yielded temples and/or shrines from the IRON AGE to the ROMAN period.

1- Survey briefly the archaeological evidence related to these sacred buildings by saying where (the site) shrines were found, to which period they date and to which deity they were dedicated.

2- Discuss in detail **ONLY ONE** of these shrines or temples. In the discussion stress the preserved cultic features and the evidence that helped identify the deity worshipped there.

3- What can you conclude about the influence of foreign cultures on local religion?

Essay question 2: maximum 2 pages

Archaeological excavations have yielded a large amount of information about FUNERARY CUSTOMS and RITUALS in IRON AGE Lebanon. What do you know about these practices?